

STORM MH
RM = 45.50
8" CONC=49.02 (E)
12" CONC=40.29 (W)
24" CONC=38.29 (N)
24" CONC=38.14 (S)

SANITARY MH
RM = 42.41
6" PVC=40.41 (NW)
6" PVC=40.21 (N)
6" PVC=40.21 (S)

CATCH BASIN
RM = 41.84
4" CONC=41.29 (SW)
4" CONC=41.19 (NE)

SAN MH
RM = 42.20
4" PVC=37.70 (NE)
4" PVC=37.70 (SW)

50137
31.50
C-BM.FND
9201 C.2016

S 1ST STREET

COWLITZ STREET

STRAND STREET

LITZ STREET

COLUMBIA RIVER

CATCH BASIN
RM = 38.81
10" CONC=33.31 (SE)

CATCH BASIN
RM = 36.75
6" PVC=34.85 (S)

SAN MH
RM = 37.28
8" DI=35.28 (N)
8" DI=35.18 (E)

STORM DRAIN
RM = 35.39

SAN MH
RM = 33.03
8" DI=30.63 (N)
8" DI=30.63 (W)
8" DI=30.43 (E)

CATCH BASIN
RM = 32.93
6" PVC=31.88 (E)

CATCH BASIN
RM = 30.39
10" CPP=28.54 (S)

STORM MH
RM = 27.42
24" CONC=18.31 (NE)
24" CONC=18.21 (SW)

STORM MH
RM = 37.45
8" DI=33.95 (W)
24" CONC=30.25 (N)
24" CONC=30.05 (E)

SAN MH
RM = 36.40
6" PVC=34.10 (N)
6" PVC=31.20 (SE)

SAN MH
RM = 36.41
6" PVC=31.01 (NW)
6" PVC=30.91 (SE)

CATCH BASIN
RM = 34.96
8" DI=33.45 (S)

CATCH BASIN
RM = 31.22
6" PVC=29.72 (N)

STORM MH
RM = 32.29
24" CONC=23.87 (W)
24" CONC=22.87 (E)
(N & S OBTSTRUCTED)

CATCH BASIN
RM = 29.40
6" DI=27.90 (SE)

CATCH BASIN
RM = 28.83
6" DI=27.33 (NW)
12" CONC=26.33 (W,SW)
15" CMP=25.83 (E)

SAN MH
RM = 29.47
10" CONC=26.77 (N)
10" CONC=26.07 (W)
10" CONC=25.87 (S)

SAN MH
RM = 29.71
10" CONC=25.61 (N)
12" CONC=25.41 (W)

SAN MH
RM = 34.69
6" PVC=29.44 (N)
6" PVC=28.14 (W)
6" PVC=28.94 (SE)

SAN MH
RM = 34.54
6" PVC=30.94 (S)
6" PVC=29.64 (W)
6" PVC=29.44 (E)

SAN MH
RM = 34.60
8" PVC=29.30 (NW)
10" DI=23.20 (S)
12" DI=22.10 (E)

CATCH BASIN
RM = 33.85
6" PVC=31.75 (W)
6" CPP=31.65 (E)

STORM MH
RM = 34.39
8" CPP=29.89 (SW)
12" CPP=29.29 (SE)

SAN MH
RM = 34.70
12" CONC=24.70 (NE)
12" CONC=21.85 (E)
12" DI=21.80 (W)
12" CONC=21.50 (N)

SAN MH
RM = 33.95
8" DI=29.99 (W)
10" DI=22.78 (S)
10" DI=22.48 (N)

STORM MH
RM = 31.47
10" DI=27.17 (E,W)
12" CPP=23.82 (N)
12" CPP=23.07 (S)

CATCH BASIN
RM = 30.36
10" DI=28.56 (W)

CATCH BASIN
RM = 29.42
8" DI=28.42 (E)

CATCH BASIN
RM = 28.21
12" CPP=25.11 (SE)

CATCH BASIN
RM = 28.64
10" DI=26.63 (W)

STORM MH
RM = 36.21
16" CPP=28.11 (S)
16" CPP=28.91 (E)

8
27.61

16" CPP
IE = 20.85

10" DI
IE = 15.55

10" DI
IE = 15.55

10" DI
IE = 15.55

10" DI
IE = 15.55

10" DI
IE = 15.55

10" DI
IE = 15.55

10" DI
IE = 15.55

10" DI
IE = 15.55

10" DI
IE = 15.55

10" DI
IE = 15.55

10" DI
IE = 15.55

10" DI
IE = 15.55

10" DI
IE = 15.55

10" DI
IE = 15.55

10" DI
IE = 15.55

10" DI
IE = 15.55

10" DI
IE = 15.55

10" DI
IE = 15.55

10" DI
IE = 15.55

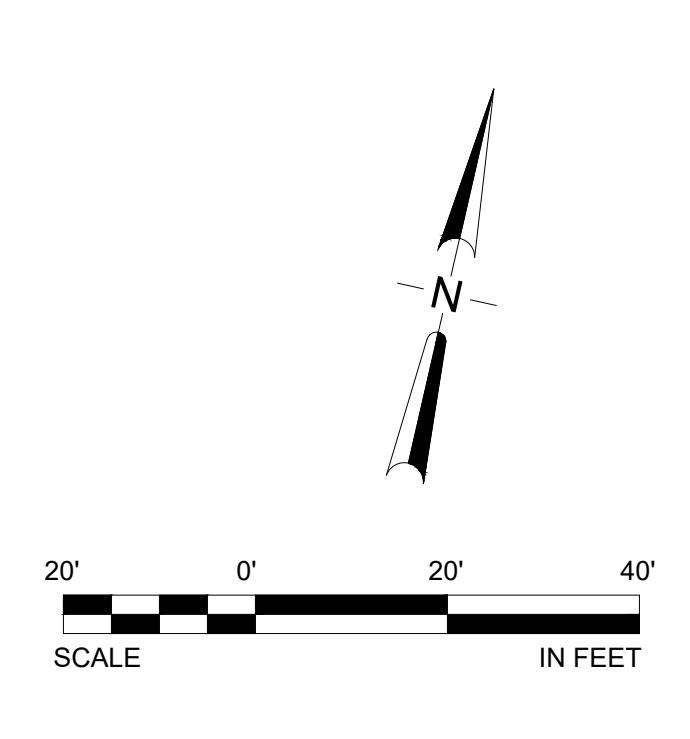

S 2ND STREET

PLYMOUTH STREET

HYDRANT FLANGE & VALVE W/O L/D

10 YEAR FLOOD ELEV. (ELEV. = 36.6)

ORDINARY LOW WATER (ELEV. = 2.9)

ORDINARY HIGH WATER (ELEV. = 14.6)

FLOODPLAIN LMT

5
#30.05

STORM MH
1.5X1.5 METAL L/D
RIM = 24.58

CATCH BASIN
RIM = 26.94
6" CONC=23.84 (N)
6" CONC=23.44 (S)

SANITARY MH
RIM = 27.44

4
#27.52

CONCRETE BLOCK

CONCRETE BLOCK

HYDRANT FLANGE & VALVE W/O L/D

CATCH BASIN
RIM = 27.59
6" CONC=24.09 (N)
8" CONC=24.09 (S)
10" PVC=23.89 (E)

STORM MH
RIM = 24.89
10" PVC=16.63 (N)
10" PVC=16.43 (E)

CATCH BASIN
RIM = 25.47
6" PVC=23.62 (S)

3
#28.68

1" CONCRETE RETAINING WALL

1" CONCRETE RETAINING WALL

10 YEAR FLOOD ELEV. (ELEV. = 34.0)

ORDINARY LOW WATER (ELEV. = 2.9)

ORDINARY HIGH WATER (ELEV. = 14.6)

FLOODPLAIN LMT

CATCH BASIN
RIM = 25.24
6" PVC=22.89 (N,S)

WOOD STAKE

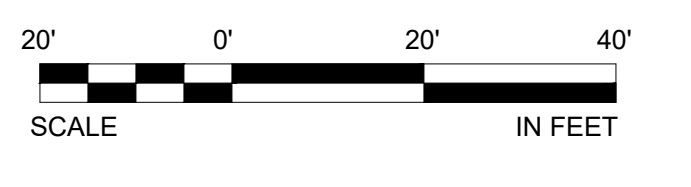
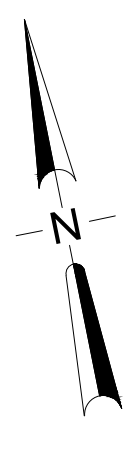



UMATILLA STREET

SCALE IN FEET

11
36.47

STORM MH
RIM = 81.16
8" CPP=77.88 (N)
8" CPP=77.58 (S)
(8" DI WM RUNS THROUGH)

CATCH BASIN
RIM = 80.50
8" DI=77.60 (N)
8" DI=77.50 (E)

CATCH BASIN
RIM = 77.34
8" DI=75.44 (NW)
8" DI=75.14 (S)

CATCH BASIN
RIM = 75.48
8" DI=73.83 (N)
8" DI=73.53 (SE)

CATCH BASIN
RIM = 69.74
8" DI=67.79 (NW)
8" CPP=67.74 (SE)

STORM MH
RIM = 45.80
12" CMP=40.25 (NW)
10" PVC=39.45 (NE)
24" CONC=38.55 (SE)

CATCH BASIN
RIM = 47.60
8" CPP=45.40 (NW)
12" PVC=45.05 (SE)

CATCH BASIN
RIM = 43.68
12" PVC=41.13 (NW)
12" PVC=41.03 (SE)

SEWER TREATMENT
PLANT BUILDING
SSCO
RIM = 44.18

17
45.34
C-BC

