

36  
R 334 #4 HdCu - 1s  
R 167 2 AAC Iris  
R 1 GRND POLE  
R 1 L COBRA 95 LED  
R 1 L MASTARM 6  
R 1 OT 1-PH BANK  
R 1 OT 50 1B 120  
R 1 POLE 45/3

31  
N 166 350 AL TX Wesleyan  
N 151 UCPC 3  
N 2 UCPC EL3  
N 1 UV SC-C6

35  
N 132 350 AL TX Wesleyan  
N 92 UCPC 3  
N 2 UCPC EL3  
N 1 USR 3  
R 92 #2 AL TX Clam  
R 1 ANC R72  
R 1 GUY SW3/8

26  
N 1323 4/0 AI 15 kv 1/3 N  
N 6 UP COVER  
N 6 UP ELB 4/0  
N 3 UP SWMOD 4W  
N 1 UV SWITCH 3PSM

5  
N 705 4/0 AI 15 kv 1/3 N  
N 1 ANC R531  
N 3 OP C/O XARM W/G  
N 1 UPR 3X3  
R 651 #2 HdCu - 1s  
R 217 2 AAC Iris

27  
N 239 1/0 AI 15 kv Full N  
N 1 PMT STD FFT  
N 224 UCPC 2  
N 2 UCPC EL2  
N 1 UT 1-PH BANK  
N 1 UT 75 STD 120

33  
N 26 4/0 AL TX Sweetbriar  
N 11 UCPC 3  
N 2 UCPC EL3

30  
N 186 350 AL TX Wesleyan  
N 171 UCPC 3  
N 2 UCPC EL3  
N 1 UV SC-C

29  
R 242 #4 HdCu - 1s  
R 121 2 AAC Iris  
R 1 C20-10-1  
R 1 GRND POLE  
R 1 L COBRA 95 LED  
R 1 L MASTARM 6  
R 1 OP C/O XARM  
R 1 OT 10 1B 120  
R 1 OT 2-PH BANK  
R 1 OT 50 1B 120  
R 1 POLE 45/3  
R 1 USR 2  
R 1 USR 3

13  
N 456 4/0 AI 15 kv 1/3 N  
N 1 ANC R531  
N 1 GUY 30 D3/8  
N 1 GUY 96 D3/8  
N 3 OP C/O XARM W/G  
N 1 UPR 3X3

37  
R 483 #1 HdCu - 3s  
R 161 #4 HdCu - 1s  
R 1 ANC R301  
R 1 ANC R531  
R 1 C40-10-5  
R 1 C50-10-5  
R 1 GUY 96 D3/8  
R 1 GUY 96 SW3/8  
R 1 L COBRA 95 LED  
R 2 OP C/O XARM  
R 1 OT 10 1B 120  
R 1 OT 1-PH BANK  
R 1 POLE 45/4

28  
N 133 1/0 AI 15 kv Full N  
N 118 UCPC 2  
N 1 UP ELB 1/0  
R 64 1/0 AI 15 kv Full N  
R 1 UP ELB 1/0

39  
R 232 1/0 AI 15 kv Full N  
R 1 A40-15-5  
R 1 C60-10-5  
R 2 GUY 96 D3/8  
R 1 L COBRA 95 LED  
R 1 L MASTARM 6  
R 75 LABOR OH  
R 1 OT 1-PH BANK  
R 1 OT 25 1B 120  
R 1 POLE 45/3  
R 2 UCPC EL2

34  
N 95 350 AL TX Wesleyan  
N 80 UCPC 3  
N 2 UCPC EL3

16  
R 57 4/0 AL QX Appaloosa  
R 1 POLE 40/4

17  
R 378 #2 HdCu - 1s  
R 126 2 AAC Iris  
R 1 C20-10-2  
R 1 L COBRA 95 LED  
R 1 L MASTARM 6  
R 3 OT 15 1B 277  
R 1 OT 3-PH BANK  
R 1 POLE 45/3

20  
N 227 1/0 AI 15 kv Full N  
N 212 UCPC 2  
N 2 UCPC EL2  
N 1 UT 1-PH BANK  
N 1 UT 25 STD 120  
N 1 UV TRANS PAD

7  
R 405 #1 HdCu - 3s  
R 135 #4 HdCu - 1s  
R 1 C20-10-2  
R 1 C22-10-2  
R 1 L COBRA 95 LED  
R 1 L MASTARM 6  
R 1 POLE 45/3

2  
N 1173 4/0 AI 15 kv 1/3 N  
N 1023 UCPC 3 (3 RUNS X 341)  
N 6 UCPC EL3  
N 3 UP COVER  
N 9 UP ELB 4/0  
N 1 UV SWITCH 3PSM

12  
N 133 350 AL TX Wesleyan  
N 118 UCPC 3  
N 3 UCPC EL3  
N 1 UV SP-C

32  
N 80 350 AL TX Wesleyan  
N 1 UV SC-C6

18  
R 336 #2 HdCu - 1s  
R 112 2 AAC Iris  
R 1 C20-10-2  
R 1 L COBRA 40 LED  
R 1 L MASTARM 8  
R 1 OT 1-PH BANK  
R 1 OT 25 1B 120  
R 1 POLE 45/4

8  
N 363 1/0 AI 15 kv Full N  
N 1 PMT STD FFT  
N 121 UCPC 2  
N 2 UCPC EL2  
N 2 UP COVER  
N 1 UP ELB 1/0  
N 9 UP ELB 4/0  
N 1 UT 1-PH BANK  
N 1 UV TRANS PAD

21  
N 42 4/0 AL TX Sweetbriar  
N 27 UCPC 3  
N 2 UCPC EL3

38  
R 138 4/0 AL TX Zuzara  
R 1 ANC 1HLX  
R 2 GUY D3/8  
R 1 L COBRA 40 LED  
R 1 FS  
R 1 L MASTARM 8  
R 1 POLE 45/1  
R 1 USR 2

19  
R 465 #2 HdCu - 1s  
R 155 2 AAC Iris  
R 1 ANC 1HLX  
R 1 C40-10-5  
R 2 GUY D3/8  
R 1 L COBRA 40 LED  
R 1 L MASTARM 6  
R 1 POLE 45/4

11  
N 1308 4/0 AI 15 kv 1/3 N  
N 386 UCPC 3 (3 RUNS X 386)  
N 2 UP COVER  
N 1 UP ELB 1/0  
N 9 UP ELB 4/0  
N 1 UP SWMOD 4W  
N 1 UV SWITCH 3PSM

9  
N 969 4/0 AI 15 kv 1/3 N  
N 819 UCPC 3 (3 RUNS X 273)  
N 3 UP COVER  
N 9 UP ELB 4/0  
N 3 UP SWMOD 4W  
N 1 UV SWITCH 3PSM

15  
N 1038 4/0 AI 15 kv 1/3 N  
N 888 UCPC 3 (3 RUNS X 296)



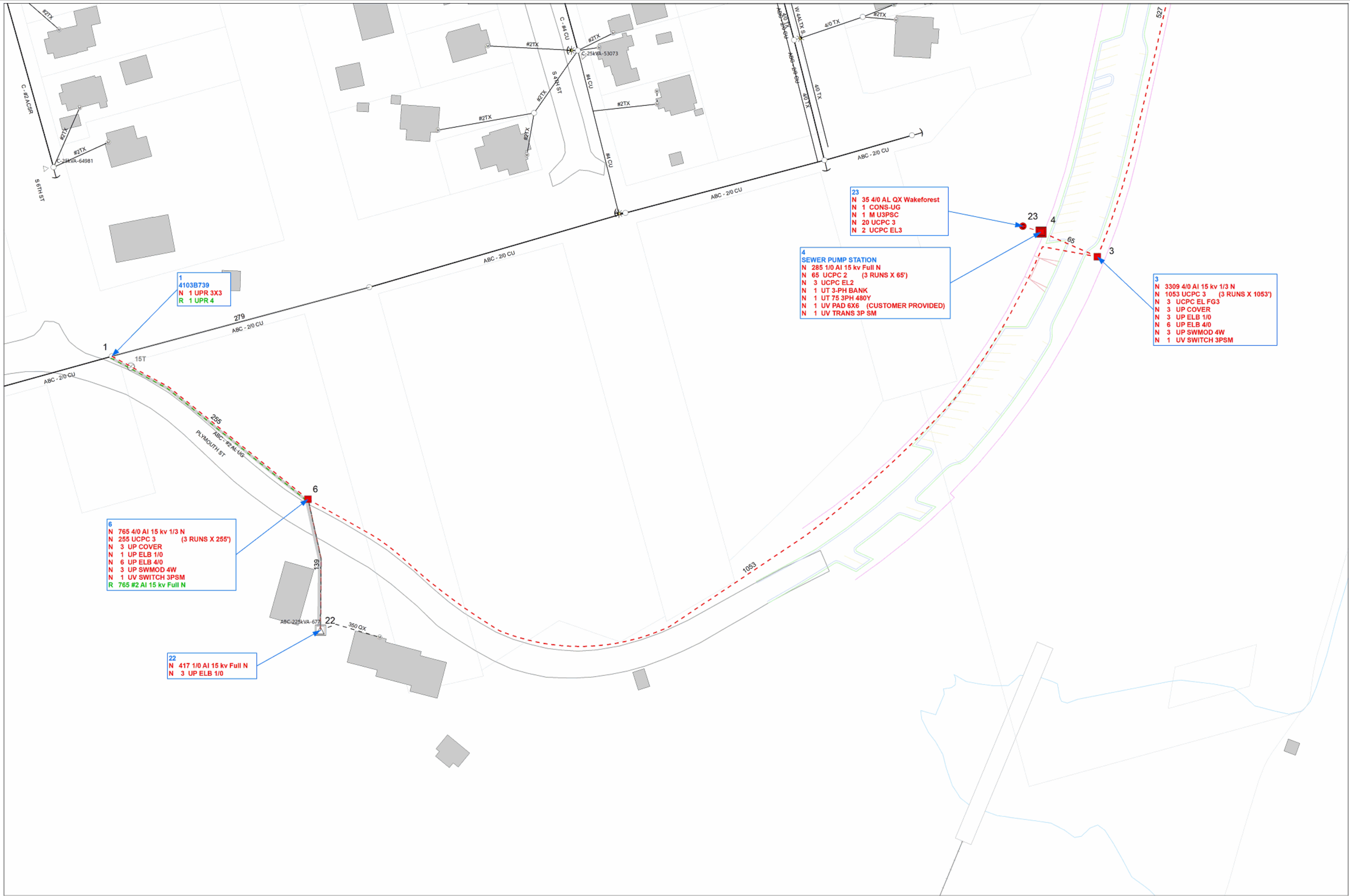

**1**  
4103B739  
N 1 UPR 3X3  
R 1 UPR 4

**6**  
N 765 4/0 AI 15 kv 1/3 N  
N 255 UCPC 3 (3 RUNS X 255')  
N 3 UP COVER  
N 1 UP ELB 1/0  
N 6 UP ELB 4/0  
N 3 UP SWMOD 4W  
N 1 UV SWITCH 3PSM  
R 765 #2 AI 15 kv Full N

**22**  
N 417 1/0 AI 15 kv Full N  
N 3 UP ELB 1/0

**4**  
**SEWER PUMP STATION**  
N 285 1/0 AI 15 kv Full N  
N 65 UCPC 2 (3 RUNS X 65')  
N 3 UCPC EL2  
N 1 UT 3-PH BANK  
N 1 UT 75 3PH 480Y  
N 1 UV PAD 6X6 (CUSTOMER PROVIDED)  
N 1 UV TRANS 3P SM

**23**  
N 35 4/0 AL QX Wakeforest  
N 1 CONS-UG  
N 1 M U3PSC  
N 20 UCPC 3  
N 2 UCPC EL3

**3**  
N 3309 4/0 AI 15 kv 1/3 N  
N 1053 UCPC 3 (3 RUNS X 1053')  
N 3 UCPC EL FG3  
N 3 UP COVER  
N 3 UP ELB 1/0  
N 6 UP ELB 4/0  
N 3 UP SWMOD 4W  
N 1 UV SWITCH 3PSM