

CITY OF ST. HELENS  
DEPARTMENT OF PUBLIC WORKS  
PLANS FOR PROPOSED PROJECT

# S. 1st Street at St. Helens Street

## Franchise Utility Improvements

January, 2024

A01	Cover Sheet & Index
A02	Survey Control
A03	General Notes
B01	Details
B02	Utility Trench Details
U01	Joint Utility Plan
U02	Vault Details
U03	Conduit Routing Details

## OWNER

City of St. Helens  
Contact: Sharon Darroux, PMP  
265 Strand Street  
St Helens, OR 97051  
Email: [sdarroux@sthelensoregon.gov](mailto:sdarroux@sthelensoregon.gov)

## CIVIL ENGINEER

**Kittelson & Associates, Inc.**  
Contact: Caleb Cox, P.E.  
851 SW 6th Avenue, Suite 600  
Portland, OR 97204  
Tel: 503-535-7453  
Email: ccox@kittelson.com

SURVEYOR

S&F Land Services  
Contact: Chris Sherby, PLS  
4858 SW Scholls Ferry Rd, Ste A  
Portland, OR 97225  
Email: [chris.sherby@sflands.com](mailto:chris.sherby@sflands.com)

## UTILITES

NW Natural  
Contact: Curtis Babcock  
Tel: 971-352-5166  
Email: [curtis.babcock@nwnatural.com](mailto:curtis.babcock@nwnatural.com)

COMCAST  
Contact: Ryan Hennessey  
750 11th Ave.  
Longview, WA 98632  
Tel: 360-846-8734  
Email: [Ryan\\_Hennessey@comcast.com](mailto:Ryan_Hennessey@comcast.com)

**LUMEN**  
Contact: Don Sheeran  
4501 NE Minnehaha St Bldg 2  
Vancouver, WA 98661  
Tel: 503-422-0483  
Email: donal.sheeran@lumen.com

Contact: Brandon Aman  
Tel: 701-866-7952  
Email: [baman@terratechllc.net](mailto:baman@terratechllc.net)

**FAT BEAM**  
Contact: Christine Ganoung  
2065 W. Riverstone Dr, Suite 202  
Coeur d'Alene, ID 83814  
Tel: 208-916-8054  
Email: [christine.ganoung@fatbeam.com](mailto:christine.ganoung@fatbeam.com)

Contact: Ty Snyder  
2065 W. Riverstone Dr, Suite 202  
Coeur d' Alene, ID 83814  
Email: [ty.snyder@fatbeam.com](mailto:ty.snyder@fatbeam.com)

CRPUD  
Contact: Brooke Sisco  
PO Box 1193  
St. Helens, OR 97051  
Tel: 971-225-8328  
bsisco@crpud.com

Contact: Karl Webster  
PO Box 1193  
St. Helens, OR 97051  
Tel: 503-397-8154  
kwebster@crpud.com

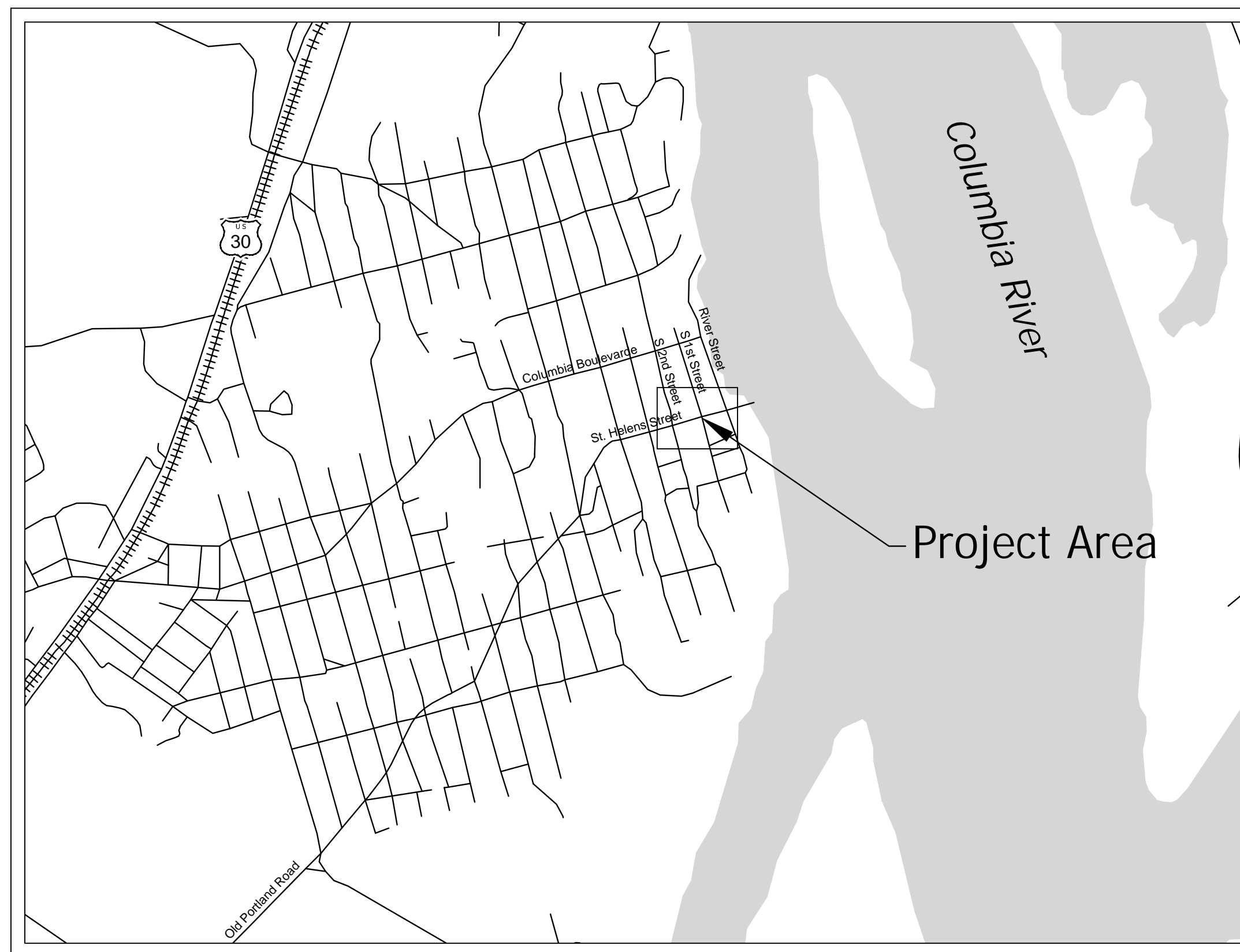

SITE VICINITY MAP  
N.T.S.

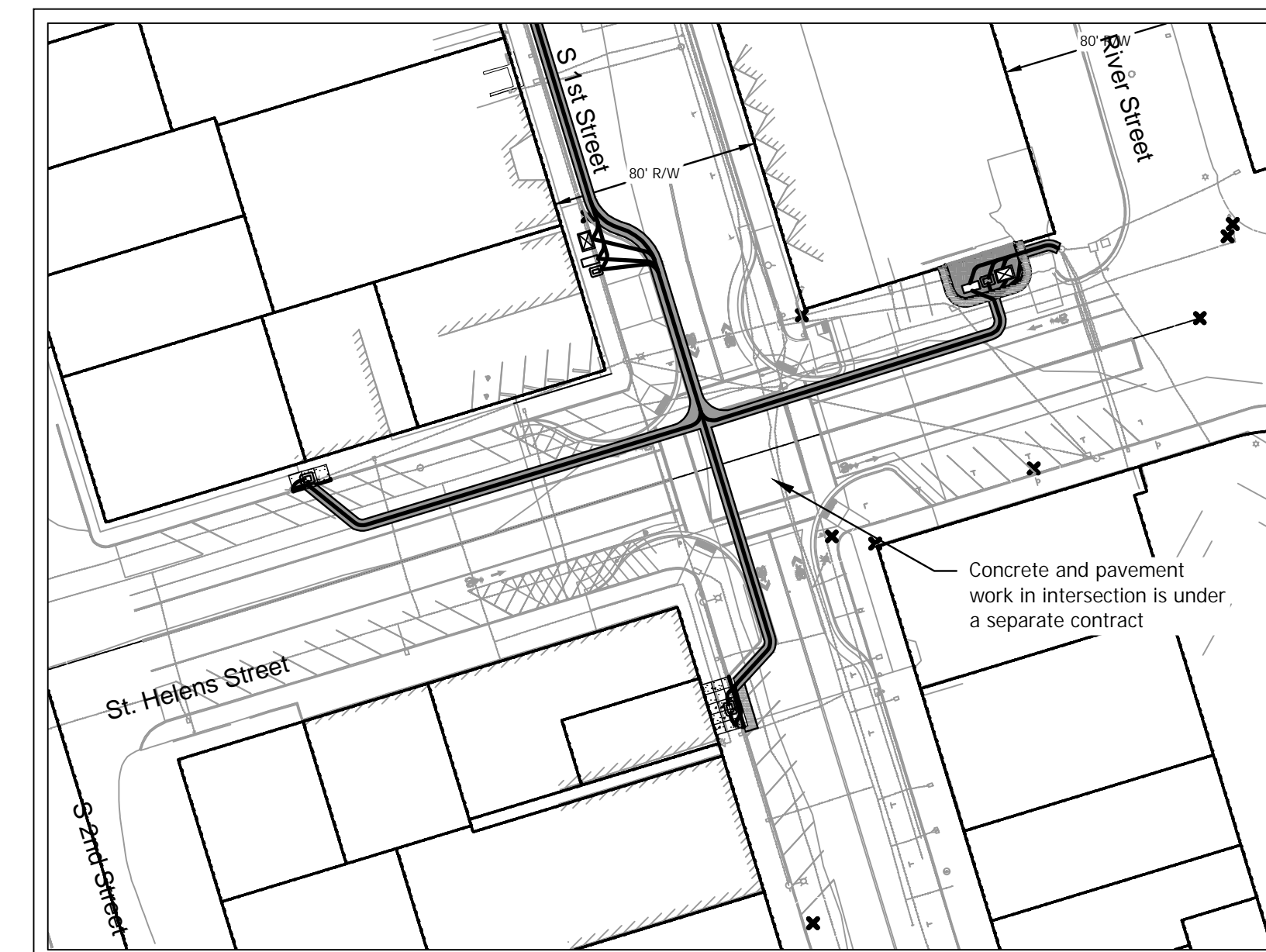

SITE PLAN  
N.T.S.

## LOCATES

(48 HOUR NOTICE PRIOR TO EXCAVATION)



Know what's **below**.  
Call before you dig.

OREGON LAW REQUIRES YOU TO FOLLOW THE RULES ADOPTED BY THE OREGON UTILITY NOTIFICATION CENTER. THOSE RULES ARE SET FORTH IN OAR 952-001-0010 THROUGH OAR 952-001-0090. YOU MAY OBTAIN COPIES OF THE RULES FROM THE CENTER BY CALLING (503) 246-1987

ONE CALL SYSTEM 1-800-332-2344

**PUBLIC WORKS SUPERVISOR, DAVE ELDER (503) 397-3532, MUST BE NOTIFIED 48 HOURS IN ADVANCE TO COORDINATE ANY TAPS OR WATER VALVE OPERATION. THE CONTRACTOR IS NOT ALLOWED TO OPERATE ANY WATER VALVES CONTROLLING FLOW TO NEW PIPING FROM THE CITY'S POTABLE WATER SYSTEM**

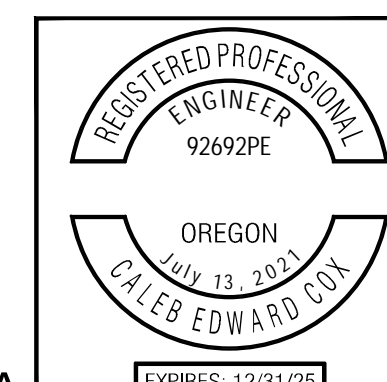

City Project No. R-685A



**KITTELSON  
& ASSOCIATES**

610 SW ALDER STREET, SUITE 700  
PORTLAND, OR 97205  
P 503.228.5230 F 503.273.8169

[illegible]

Submission Date:  
01/12/2024

Drawn: DZS	Designed: CEC	Checked: AMR
---------------	------------------	-----------------

PROJECT NO.  
23544

S. 1st Street at St. Helens Street  
Franchise Utility Improvements

COVER SHEET &amp; INDEX

SHEET NO.  
A01



## GENERAL NOTES

1. ALL WORK SHALL BE IN ACCORDANCE WITH THE CURRENT AND APPLICABLE REGULATIONS, SPECIFICATIONS, CODES, AND REQUIREMENTS OF CITY OF ST. HELENS, THE OREGON STATE PLUMBING SPECIALTY CODE (UPC), AND THE OREGON STATE STRUCTURAL SPECIALTY CODE (OSSC).
2. THE CONTRACTOR SHALL PERFORM ALL WORK NECESSARY TO COMPLETE THIS PROJECT IN ACCORDANCE WITH THE PLANS INCLUDING SUCH INCIDENTALS AS MAY BE NECESSARY TO MEET APPLICABLE AGENCY REQUIREMENTS AND AS NECESSARY TO PROVIDE A COMPLETED PROJECT.
3. THE CONTRACTOR SHALL OBTAIN ALL REQUIRED PERMITS AND LICENSES PRIOR TO COMMENCING WORK ON THIS PROJECT.
4. THE CONTRACTOR SHALL KEEP A COPY OF ALL REQUIRED PERMITS AND AN APPROVED SET OF PLANS WITH ALL APPROVED REVISIONS ON THE PROJECT SITE AT ALL TIMES.
5. THE EXISTING AND APPROXIMATE LOCATION OF KNOWN UNDERGROUND UTILITIES OR STRUCTURES SHOWN ON THESE DRAWINGS WERE DETERMINED BY A SEARCH OF AVAILABLE PUBLIC RECORDS AND AS-BUILTS. THE LOCATIONS AND DEPTHS OF THESE UTILITIES ARE FROM THESE RECORDS AND ARE SHOWN FOR THE CONVENIENCE OF THE CONTRACTOR. NO RESPONSIBILITY IS ASSUMED BY EITHER THE CITY OR THE ENGINEER FOR ACCURACY OR COMPLETENESS OF THESE LOCATIONS.
6. THE CONTRACTOR SHALL PROTECT AND MAINTAIN ALL EXISTING UTILITIES ON THIS SITE AND IN ADJACENT STREETS. ANY DAMAGE TO EXISTING UTILITIES, WHETHER SHOWN OR NOT ON THIS DRAWING, SHALL BE REPAIRED / REPLACED AT THE CONTRACTOR'S EXPENSE AND TO THE SATISFACTION OF THE UTILITY OWNER. EXISTING SURFACE FEATURES AND FENCING DAMAGED BY CONTRACTOR SHALL BE REPLACED IN KIND TO THE SATISFACTION OF THE CITY.
7. THE CONTRACTOR SHALL HAVE ALL EXISTING UTILITIES LOCATED PRIOR TO STARTING ANY WORK.

ATTENTION: OREGON LAW REQUIRES YOU TO FOLLOW RULES ADOPTED BY THE OREGON UTILITY NOTIFICATION CENTER. THE CONTRACTOR SHALL CALL THE OREGON UTILITY NOTIFICATION CENTER AT 503-232-1987 AT LEAST 48 HOURS, BUT NOT MORE THAN 10 BUSINESS DAYS BEFORE BEGINNING EXCAVATION. OREGON LAW REQUIRES YOU TO FOLLOW RULES ADOPTED BY THE OREGON UTILITY NOTIFICATION CENTER. THOSE RULES ARE SET FORTH IN OAR 952-001-0010 THROUGH OAR 952-001-0090. YOU MAY OBTAIN COPIES OF THE RULES BY CALLING THE ADMINISTRATIVE CENTER.

3. THE CONTRACTOR SHALL NOTIFY ALL COMPANIES AND AGENCIES WITH UNDERGROUND FACILITIES IN THE PROJECT AREA FOR 24 HOURS BEFORE COMMENCING CONSTRUCTION IN THEIR VICINITY.
9. THE CONTRACTOR SHALL BE RESPONSIBLE FOR COORDINATING THE RELOCATION OF BURIED AND OVERHEAD UTILITIES. NO SERVICE INTERRUPTIONS SHALL BE PERMITTED WITHOUT PRIOR WRITTEN AGREEMENT WITH THE UTILITY PROVIDER.
10. THE INSTALLATION OF NEW OR RELOCATION OF EXISTING ELECTRICAL, TELEPHONE, GAS, AND CABLE SERVICE SHALL BE COORDINATED BY THE CONTRACTOR WITH THE APPROPRIATE UTILITY COMPANY.
11. THE CONTRACTOR SHALL BE RESPONSIBLE FOR INSTALLATION OF UTILITY TRENCHES, CONDUIT, VAULTS, PADS, PEDESTALS, AND UTILITY TRENCH BACKFILL IN ACCORDANCE WITH STANDARD SPECIFICATIONS AND PLANS OF SERVICING UTILITIES (ELECTRICAL, TELEPHONE, GAS, AND CABLE).
12. ALL EXISTING SITE CONDITIONS AND ELEVATIONS SHOWN ON THESE DRAWINGS ARE FROM A TOPOGRAPHIC SURVEY. THE CONTRACTOR SHALL VISIT THE SITE AND VERIFY ALL EXISTING CONDITIONS AND ELEVATIONS. CONTRACTOR SHALL CONFIRM BENCHMARK LOCATION AND ELEVATION WITH SURVEYOR.
13. PROPERTY AND RIGHT-OF-WAY LINES SHOWN ARE FOR REFERENCE ONLY. THESE PLANS ARE NOT MEANT TO SERVE BOUNDARY SURVEY PURPOSES.
14. ANY ALTERATION OR VARIANCE FROM THESE PLANS SHALL BE APPROVED BY THE ENGINEER AND APPLICABLE REGULATORY AGENCY REPRESENTATIVE.
15. ANY CONSTRUCTION OBSERVATION BY CITY OF ST. HELENS, OR THE ENGINEER, SHALL NOT, IN ANY WAY, RELIEVE THE CONTRACTOR FROM ANY OBLIGATION TO PERFORM THE WORK IN STRICT COMPLIANCE WITH THE APPLICABLE CODES AND REGULATORY AGENCY REQUIREMENTS.
16. APPROVED EROSION CONTROL MEASURES SHALL BE IMPLEMENTED IN ACCORDANCE WITH REGULATORY AGENCY REQUIREMENTS. THE CONTRACTOR SHALL PROVIDE ALL MATERIAL, EQUIPMENT, AND PERSONNEL NECESSARY TO MAINTAIN SUCH EROSION PROTECTION MEASURES. ANY DAMAGE CAUSED BY EROSION SHALL BE CORRECTED BY THE CONTRACTOR AT ONCE.
17. THE CONTRACTOR SHALL MAINTAIN AND COORDINATE ACCESS TO ALL AFFECTED PROPERTIES.
18. ALL OPEN CUTTING OF EXISTING STREETS SHALL BE PATCHED WITH A C.C., COLD (TEMPORARY), HOT MIX, OR STEEL PLATING (MINIMUM 1" THICK) INSTALLED WITH NO EDGES OR CORNERS STICKING UP, AT THE CLOSE OF EACH WORK DAY. STEEL PLATING MUST BE SECURED AND MAINTAINED IN A WAY THAT WILL PREVENT BOUNCING, SHIFTING, AND MOVING VERTICALLY AND HORIZONTALLY. PLATES NEED TO BE SECURED AGAINST SHIFTING BY TACK WELDING OR OTHER APPROPRIATE DEVICE AND MUST EXTEND A MINIMUM OF 12 INCHES BEYOND THE EDGES OF THE TRENCH. TRENCHES SHALL NOT BE LEFT OPEN OVERNIGHT. SEE CITY OF ST. HELENS STD. DWG. 256 SHT. B01.
19. DEMOLITION WORK SHALL INCLUDE REMOVAL OF ALL STUMPS AND VEGETATION DEBRIS. CONFORMANCE WITH ALL REGULATIONS AND PERMITTING REQUIREMENTS FOR SUCH WORK SHALL BE THE RESPONSIBILITY OF THE CONTRACTOR.
20. IT SHALL BE THE RESPONSIBILITY OF THE CONTRACTOR TO LOCATE AND COORDINATE THE REMOVAL AND/OR ABANDONMENT OF EXISTING UTILITIES OR PROPER FILLING OF THE UTILITIES (SEPTIC TANKS, LINES, ETC.) IF THEY ARE TO REMAIN. IT SHALL ALSO BE THE RESPONSIBILITY OF THE CONTRACTOR TO CONTACT THE STATE OF OREGON WATER MASTER 503-681-7018 TO APPROVE THE FILLING OF ANY SEPTIC TANKS AND REMOVAL OF ANY EXISTING WATER WELLS.
21. ALL SURVEY MONUMENTS ON THE SUBJECT SITE, OR THAT MAY BE SUBJECT TO DISTURBANCE WITHIN THE CONSTRUCTION AREA, OR THE CONSTRUCTION OF ANY OFF-SITE IMPROVEMENTS SHALL BE ADEQUATELY REFERENCED AND PROTECTED PRIOR TO COMMENCEMENT OF ANY CONSTRUCTION ACTIVITY. IF THE SURVEY MONUMENTS ARE DISTURBED, MOVED, RELOCATED, OR DESTROYED AS A RESULT OF ANY CONSTRUCTION, THE PROJECT SHALL, AT ITS COST, RETAIN THE SERVICES OF A REGISTERED PROFESSIONAL LAND SURVEYOR IN THE STATE OF OREGON TO RESTORE THE MONUMENT TO ITS ORIGINAL CONDITION AND FILE THE NECESSARY SURVEYS AS REQUIRED BY OREGON STATE LAW. A COPY OF ANY RECORDED SURVEY SHALL BE SUBMITTED TO STAFF.

## GENERAL UTILITY NOTES

1. PIPES 6-INCHES IN DIAMETER OR LESS MAY BE ABANDONED IN PLACE BY FILLING WITH AN APPROVED CLSM AND CAPPING BOTH ENDS.
2. THE DEQ IS OPPOSED TO ANY OIL, GREASE, GASOLINE, ETC. DRAINED INTO ANY SANITARY SEWER OR STORM SEWER. DEQ WANTS ALL OIL, GASOLINE, GREASE, ETC. TO BE TREATED AS ANY OTHER HAZARDOUS WASTE WITH ON-SITE CONTAINMENT AND REMOVAL BY LICENSED HAZARDOUS WASTE DISPOSAL PROFESSIONALS. THE DEQ MAY ISSUE CITATIONS FOR INTRODUCING OIL, GAS, ETC. INTO A DRAINAGE SYSTEM THAT CONNECTS TO THE SANITARY SEWER OR THE STORM SEWER, THE FACT THAT AN OIL/WATER SEPARATOR IS INSTALLED INLINE WOULD NOT MAKE A DIFFERENCE. IT IS RECOMMENDED THAT THE DRAINS TO THE OIL/WATER SEPARATOR NOT BE INSTALLED.
3. UTILITY COMPANIES WILL FURNISH JUNCTION BOXES AND CONDUITS. CONTRACTOR WILL CONSTRUCT UTILITY TRENCH, INSTALL CONDUIT, PULL LINE, JUNCTION BOXES, AND RISERS. UTILITY COMPANIES WILL INSTALL WIRING AND MAKE FINAL CONNECTIONS
4. THE LAYOUT OF JOINT TRENCH IS BASED ON THE AVAILABLE INFORMATION. CONTRACTOR SHALL MAKE ALL NECESSARY MINOR FIELD CHANGES TO ACCOMMODATE WITH EXISTING FIELD CONDITIONS. CONTRACTOR SHALL PROVIDE PROVIDE ALL NECESSARY WORK FOR OFFSETS, CHANGES OF DIRECTION, AND ELEVATION TO AVOID CONFLICTS WITH EXISTING AND NEW FACILITIES.
5. THE CONTRACTOR IS RESPONSIBLE FOR HAVING ALL TRENCHING AND INSTALLATION INSPECTED AND APPROVED BY THE RESPECTIVE UTILITY COMPANY PRIOR TO ANY BACK FILLING WITH A 48-HOUR MINIMUM NOTICE.
6. CONTRACTOR SHALL COORDINATE WITH UTILITY COMPANIES. LACK OF TIMELINESS ON THE PART OF ANY UTILITY COMPANY SHALL NOT BE ON THE BASIS FOR ANY REQUEST FOR ADDITIONAL COMPENSATION FROM THE CITY.

## GRADING

1. PROJECT GRADING LIMITS SHALL BE ALL PROPERTY LINES AND STREET RIGHT-OF-WAY, UNLESS OTHERWISE SHOWN ON THE GRADING PLANS.
2. STRAIGHT GRADES SHALL BE CONSTRUCTED BETWEEN ALL FINISH GRADE ELEVATIONS AND/OR FINISH CONTOUR LINES SHOWN, UNLESS OTHERWISE NOTED.
3. ALL PROPOSED ELEVATIONS SHOWN SHALL BE CONSIDERED TO BE FINISH SURFACE ELEVATIONS UNLESS OTHERWISE NOTED. ALL SURFACES SHALL BE GRADED SMOOTH AND FREE OF IRREGULARITIES THAT MIGHT ACCUMULATE SURFACE WATER.
4. DUST ABATEMENT SHALL BE MAINTAINED BY ADEQUATE WATERING OF THE SITE.
5. CONTRACTOR TO REMOVE ALL UNSUITABLE MATERIAL, DEBRIS, AND ORGANIC MATERIAL WITHIN GRADING AND FILL LIMITS PRIOR TO FILL PLACEMENT. NEW FILL MATERIAL SHALL BE BENCHED INTO EXISTING GROUND IN ACCORDANCE WITH RECOMMENDATIONS IN THE GEOTECHNICAL REPORT.
6. THE REMOVAL OF UNSUITABLE MATERIAL SHALL BE DONE IN CONSULTATION WITH THE GEOTECHNICAL ENGINEER. UNSUITABLE MATERIAL SHALL BE DISPOSED OF AS DETERMINED BY THE GEOTECHNICAL ENGINEER. IF SUCH MATERIAL IS REMOVED FROM THE SITE IT SHALL BE REMOVED AT THE CONTRACTOR'S SOLE EXPENSE.
7. ALL CUT OR FILL SLOPES SHALL BE CONSTRUCTED AT NO STEEPER THAN TWO (2) HORIZONTAL TO ONE VERTICAL UNLESS OTHERWISE SHOWN ON THE PLANS.
8. THE CONTRACTOR SHALL BE RESPONSIBLE FOR ADJUSTING ALL CATCH BASINS, CLEANOUTS, MANHOLES, VAULTS, ETC., THAT ARE AFFECTED BY CONSTRUCTION AND/OR FILL TO FINISH GRADE. STORM DRAIN INLET STRUCTURES SHALL BE ADJUSTED SO WATER FLOWS INTO THE STRUCTURE WITHOUT PONDING.



**KITTELSON  
& ASSOCIATES**

610 SW ALDER STREET, SUITE 700  
PORTLAND, OR 97205  
P 503.228.5230 F 503.273.8169

[illegible]

Submission Date:  
01/12/2024

Drawn: DZS	Designed: CEC	Checked: AMR
---------------	------------------	-----------------

PROJECT NO.  
23544

**S. 1st Street at St. Helens Street  
Franchise Utility Improvements**

## GENERAL NOTES

SHEET NO  
A03

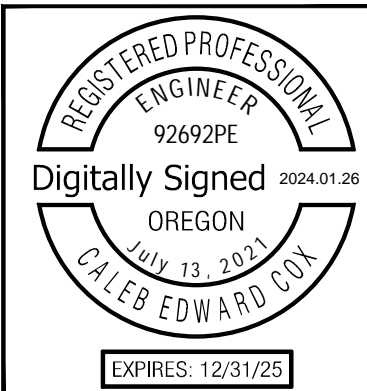



Plot Stamp: 1/11/2024 11:15:43 AM - Caleb Cox  
File: H:\23544 - 1st & St. Helens\design\CD-Franchise Utility Plans\B-Franchise Utilities-Details-23544.dwg

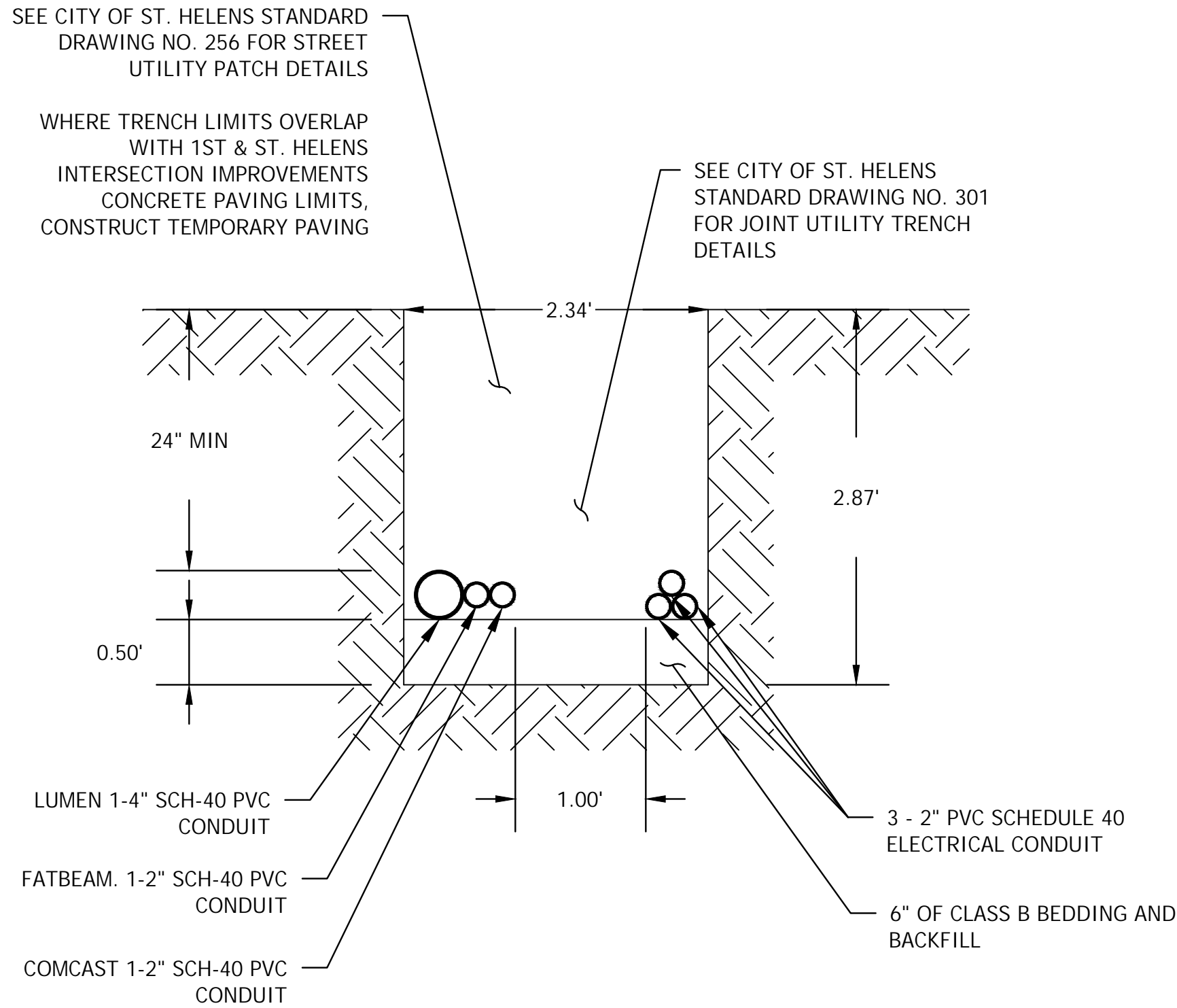

JOINT UTILITY TRENCH DETAIL A

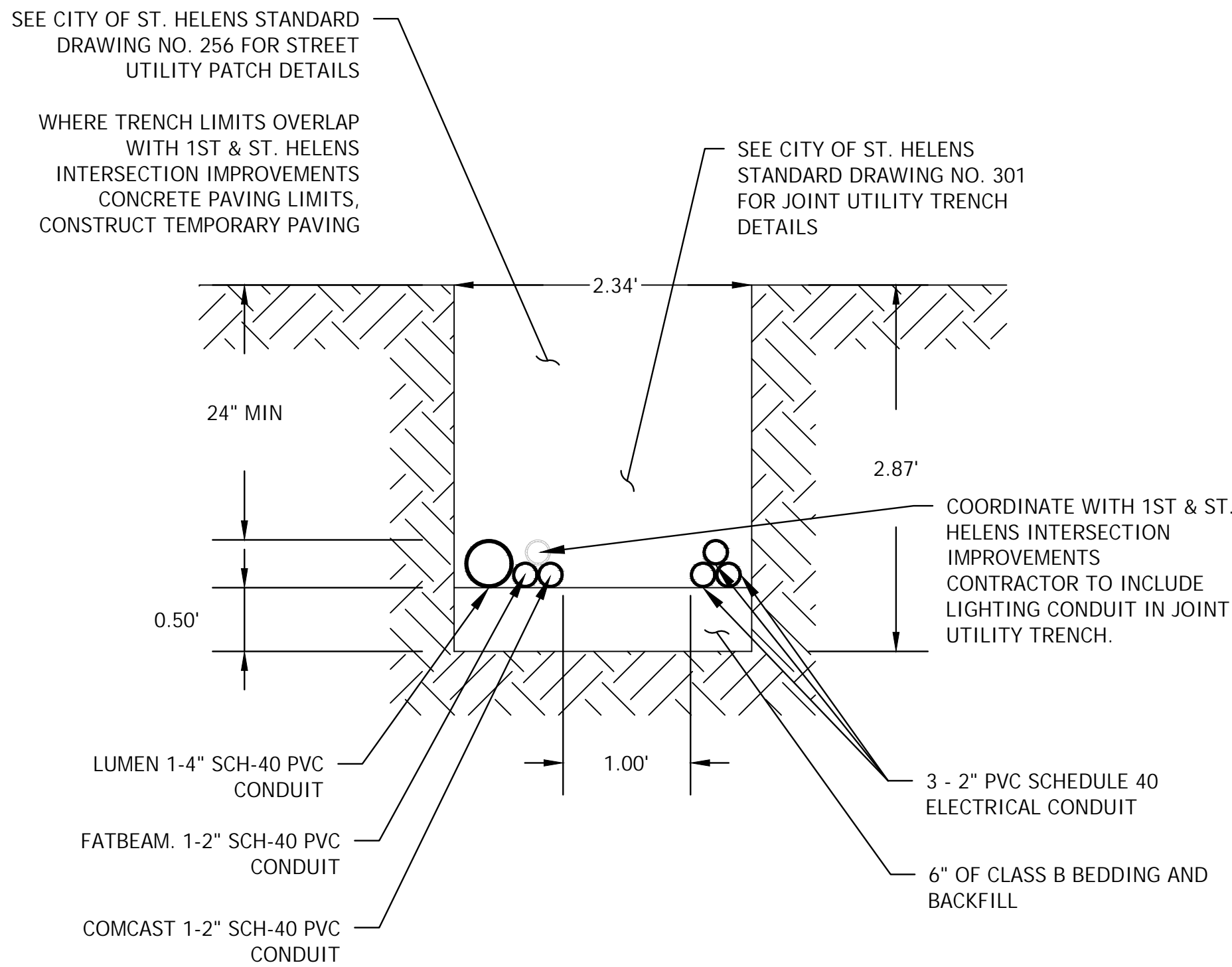

JOINT UTILITY TRENCH DETAIL B

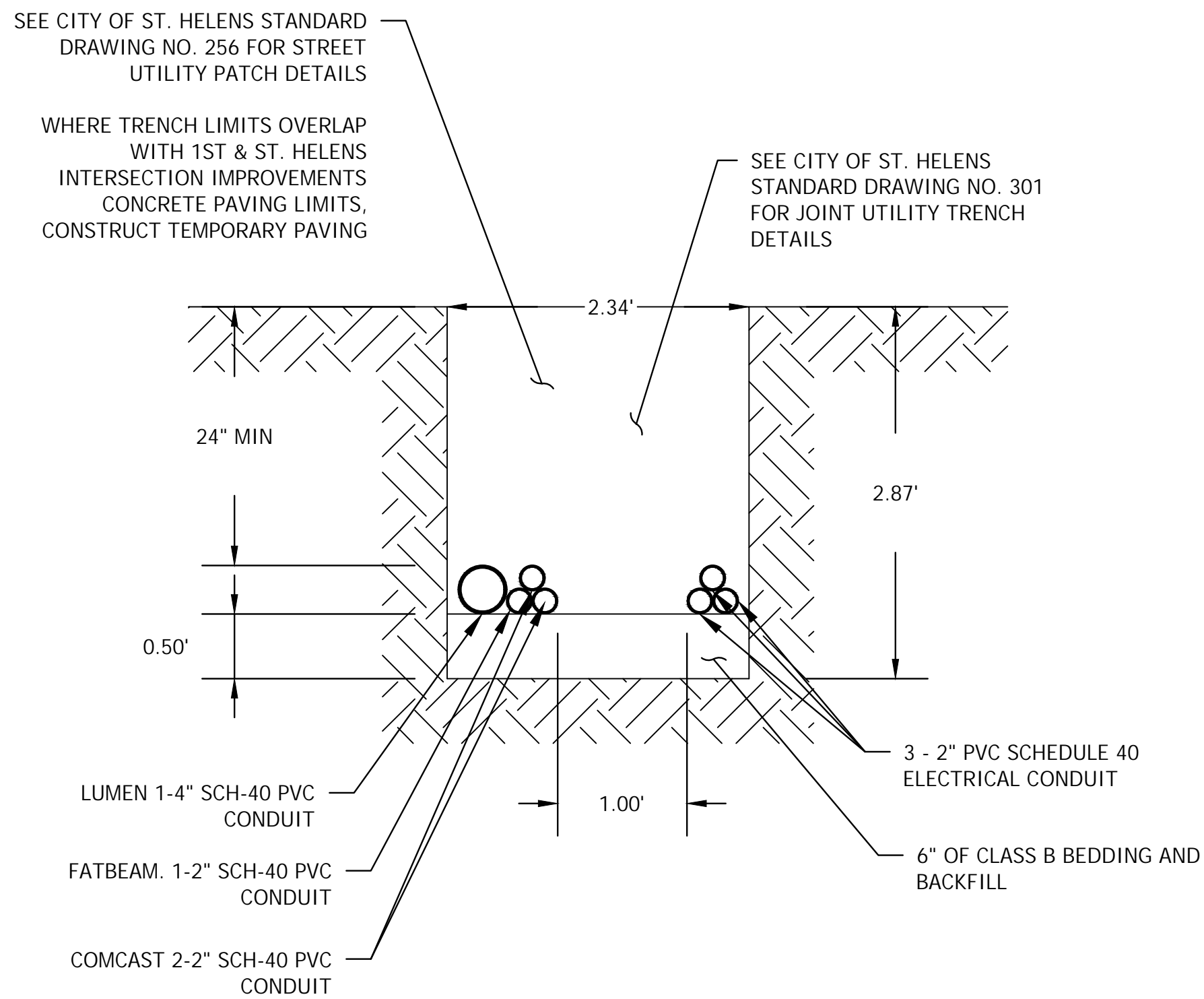

JOINT UTILITY TRENCH DETAIL C

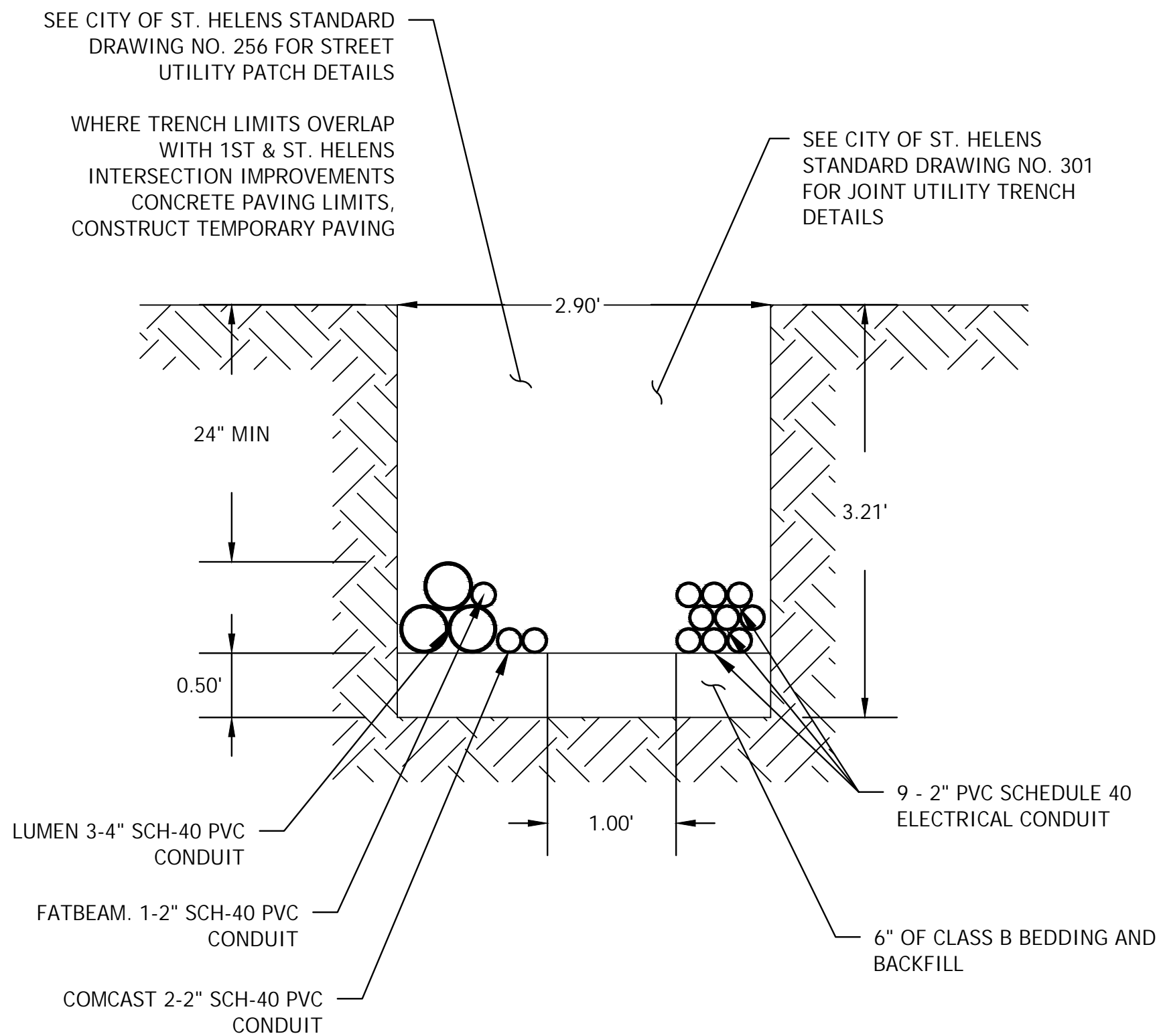

JOINT UTILITY TRENCH DETAIL D

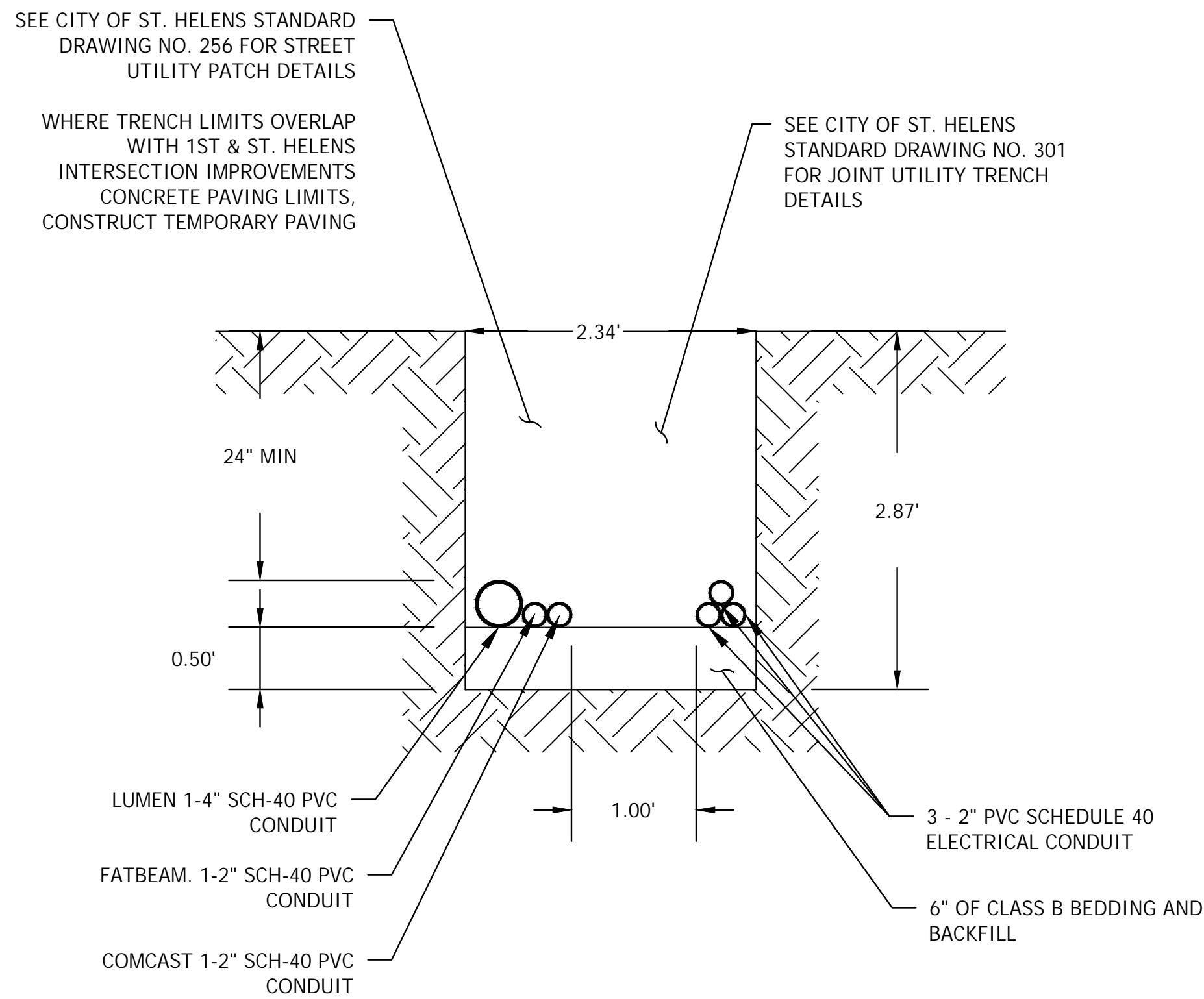

JOINT UTILITY TRENCH DETAIL E



**KITTELSON & ASSOCIATES**

610 SW ALDER STREET, SUITE 700  
PORTLAND, OR 97205  
P 503.228.5230 F 503.273.8169

#	DATE	REVISION	APP'D

Submission Date: 01/12/2024		
Drawn: DZS	Designed: CEC	Checked: AMR

PROJECT NO.  
**23544**

**S. 1st Street at St. Helens Street**  
**Franchise Utility Improvements**

UTILITY TRENCH DETAILS

SHEET NO.  
**B02**

Conduit & Vault Schedule			
Utility	2" Conduit (LF)	4" Conduit (LF)	Vaults
CRPUD	2733	0	2 - 60"x84"
Comcast	946	0	1 - 17"x30"x24"
Lumen	0	911	2 - 78"x36"x48"
Fatbeam	721	0	4 - 28"x41"x36"
<b>Total</b>	<b>4400</b>	<b>911</b>	<b>9</b>

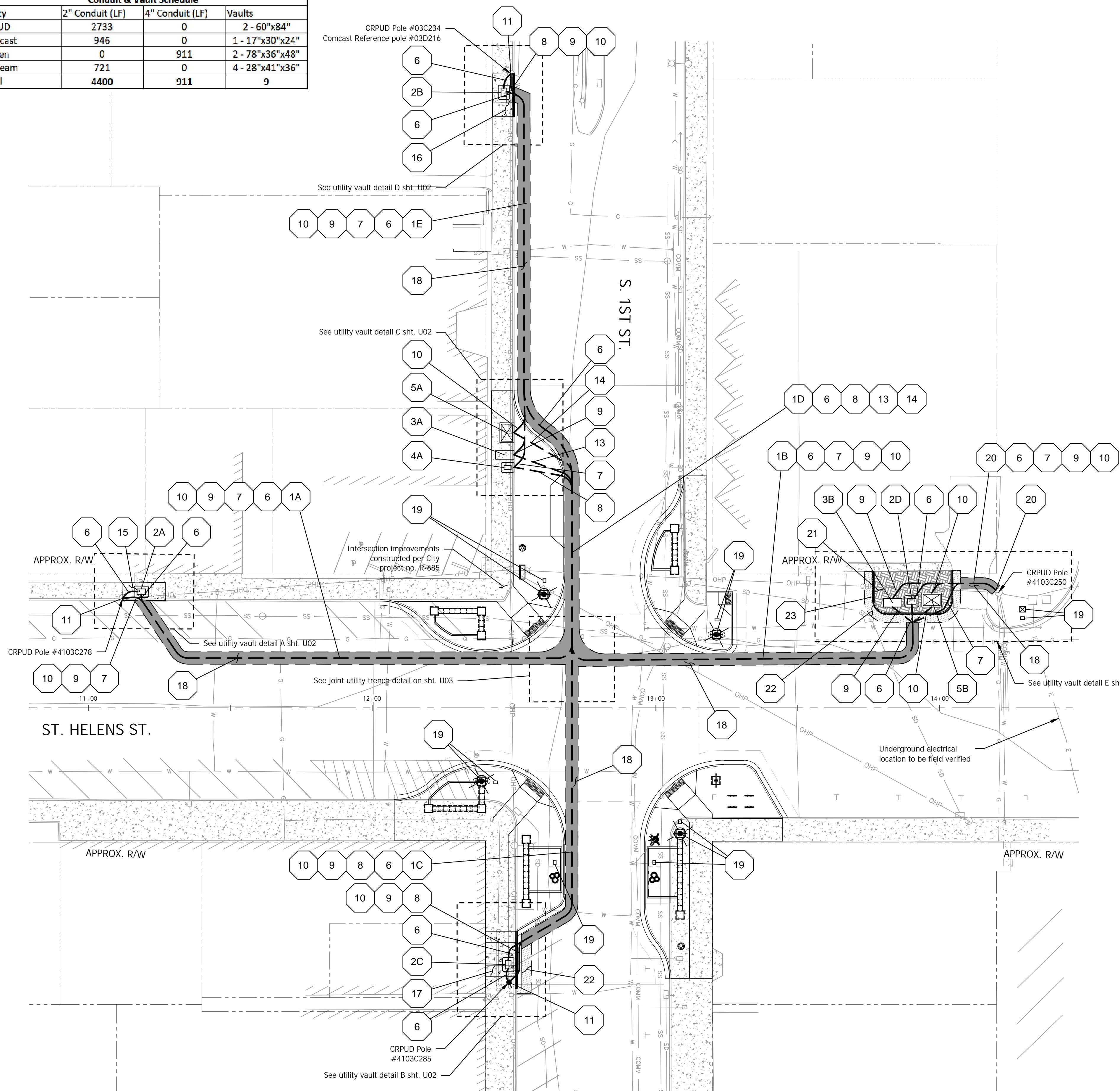

## CONSTRUCTION NOTES

- 1 Construct joint utility trench. See Sht. B02 for joint utility trench details
  - 2 Install 28" x 41" x 36" Fatbeam Vault With Concrete Apron, materials furnished by utility. See detail on sht. B01  
A: Sta. 11+18.67, 40.88' LT, ELEV. 62.92'  
B: Sta. 12+46.44, 216.81' LT, ELEV. 64.46'  
C: Sta. 12+47.95, 90.43' RT, ELEV. 53.85'  
D: STA. 13+90.11, 37.50' LT, ELEV. 50.74'
  - 3 Install 78" x 36" x 48" Lumen Vault, materials furnished by utility  
A: Sta. 12+46.72, 89.09' LT, ELEV. 59.40'  
B: Sta. 13+83.40, 37.00' LT, ELEV. 51.48'
  - 4 Install 17" x 30" x 24" Comcast Vault With Concrete Apron, materials furnished by utility. See detail on sht. B01  
A: Sta. 12+47.71, 84.66' LT, ELEV. 59.23'
  - 5 Install 60" x 84" CRPUD Vault, materials furnished by utility  
A: Sta. 12+47.49, 96.91' LT, ELEV. 59.69'  
B: Sta. 13+97.15, 38.00' LT, ELEV. 49.30'
  - 6 Install (1) 2" Fatbeam SCH-40 PVC Conduit, materials furnished by utility
  - 7 Install (1) 2" Comcast SCH-40 PVC Conduit, materials furnished by utility
  - 8 Install (2) 2" Comcast SCH-40 PVC Conduit, materials furnished by utility
  - 9 Install (1) 4" Lumen SCH-40 PVC Conduit, materials furnished by utility
  - 10 Install (3) 2" Electrical SCH-40 PVC Conduit, materials furnished by utility
  - 11 Install conduit sweeps to existing utility pole. See detail on sht. B01
  - 12 Install (4) 2" Comcast SCH-40 PVC Conduit, materials furnished by utility
  - 13 Install (3) 4" Lumen SCH-40 PVC Conduit, materials furnished by utility
  - 14 Install (9) 2" Electrical SCH-40 PVC Conduit, materials furnished by utility
  - 15 Sta. 11+12.15, 37.86' LT to 11+27.15, 37.81' LT  
Const. P.C. conc. sidewalk and Type "A" Curb (See City of St. Helens dwg. no. 210 & 220, sht. B01  
87.23 SQ FT, 15.00 LF
  - 16 Sta. 12+49.98, 208.29' LT to 12+50.01, 223.29' LT  
Const. P.C. conc. sidewalk and Type "A" Curb (See City of St. Helens dwg. no. 210 & 220, sht. B01  
104.61 SQ FT, 15.00 LF
  - 17 Sta. 12+51.07, 78.68' RT to 12+51.02, 98.68' RT  
Const. P.C. conc. sidewalk with 4' x 4' scoring pattern and Std. Curb and Gutter  
(See City of St. Helens dwg. no. 200 & 220, sht. B01)  
210.84 SQ FT, 20.00 LF
  - 18 Const. full depth A.C trench repair (See City of St. Helens dwg. no. 310, sht. B01
  - 19 Illumination Infrastructure, See 1st & St. Helens Intersection Improvements project for Illumination Plans
  - 20 Stub new conduits to the base of pole. Utilities to make final connection when utility pole is removed
  - 21 Install Bark Mulch, 4" Depth
  - 22 Const. Asphalt Pavement, Match existing asphalt and subbase thickness
  - 23 Sta. 13+76.45, 47.97' LT to 14+04.34, 48.33' LT  
Const. Type "A" Curb (See City of St. Helens dwg. no. 210, sht. B01  
53.90 FT

## GENERAL NOTES

1. Contractor is responsible for identifying and resolving utility conflicts with the proposed joint utility trench and utility vaults.
2. Contractor shall install conduits and vaults only. Utility companies will install wiring and other equipment.
3. Contractor shall coordinate with utility companies for riser connection to utility pole
4. Install polypropylene pull line in all conduits.
5. Station, offset, and elevation are referenced at the center of utility vault.
6. Temporary pedestrian access routes established by the 1st & St. Helens Intersection Improvements project shall be maintained.

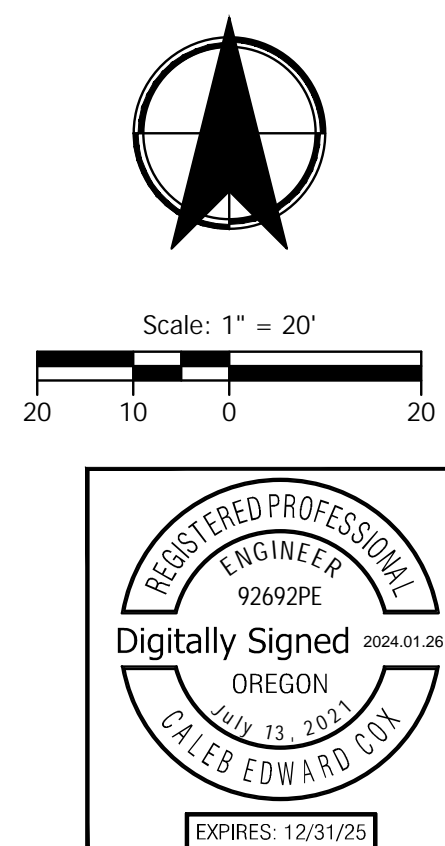

610 SW ALDER STREET, SUITE 700  
PORTLAND, OR 97205  
P 503.228.5230 F 503.273.8169

[illegible]

Submission Date: 01/12/2024		
Drawn: DZS	Designed: CEC	Checked: AMR

PROJECT NO.  
23544

S. 1st Street at St. Helens Street  
Franchise Utility Improvements

JOINT UTILITY PLAN

SHEET NO.  
U01

Plot Stamp: 1/11/2024 10:22:36 AM - Caleb Cox  
File: H:\23\23544 - 1st & St. Helens\design\CD-Franchise Utility Plans\U-Franchise Utilities-Joint Utility Plan-23544.dwg

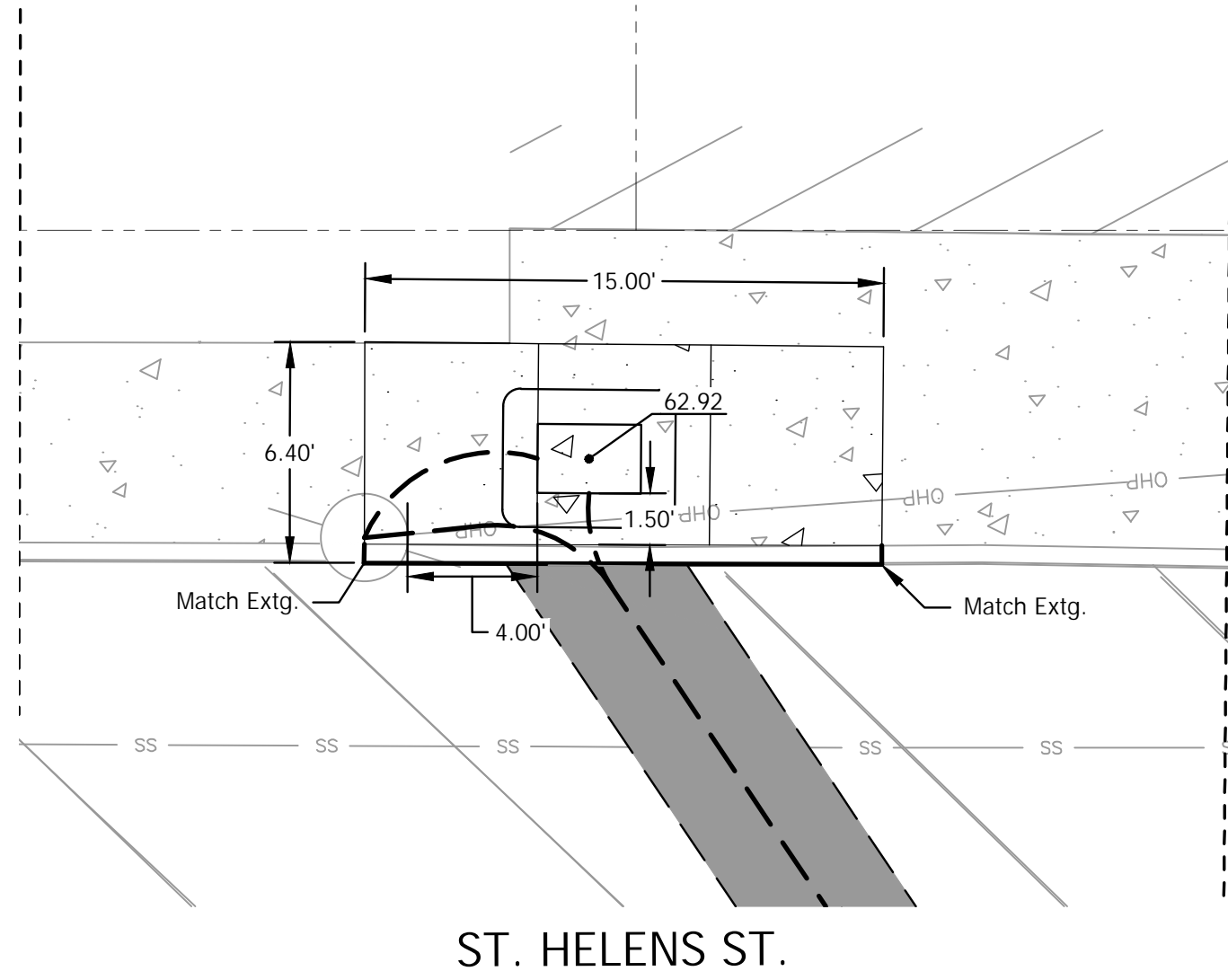

ST. HELENS ST.

UTILITY VAULT DETAIL A

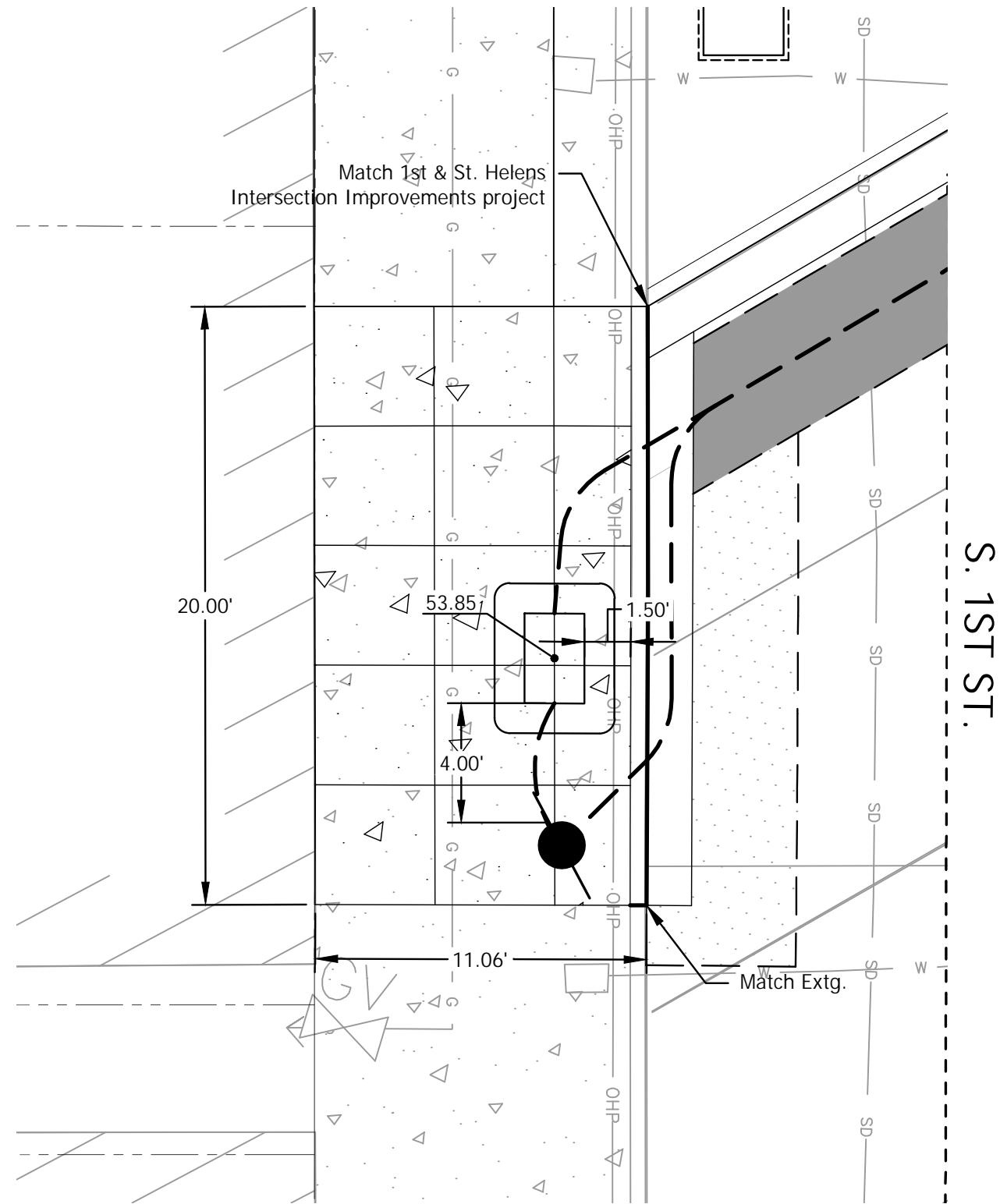

S. 1ST ST.

UTILITY VAULT DETAIL B

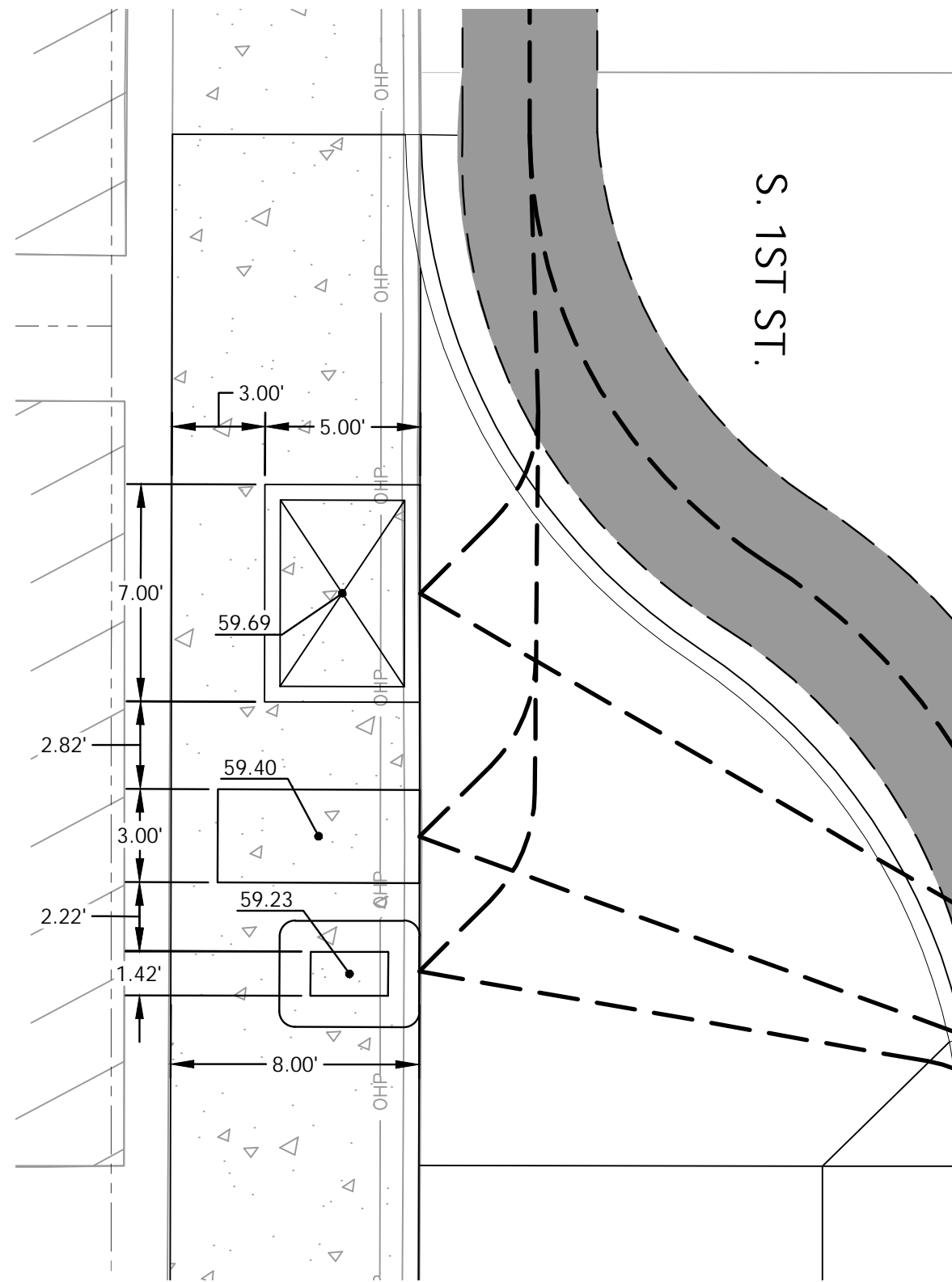

S. 1ST ST.

UTILITY VAULT DETAIL C

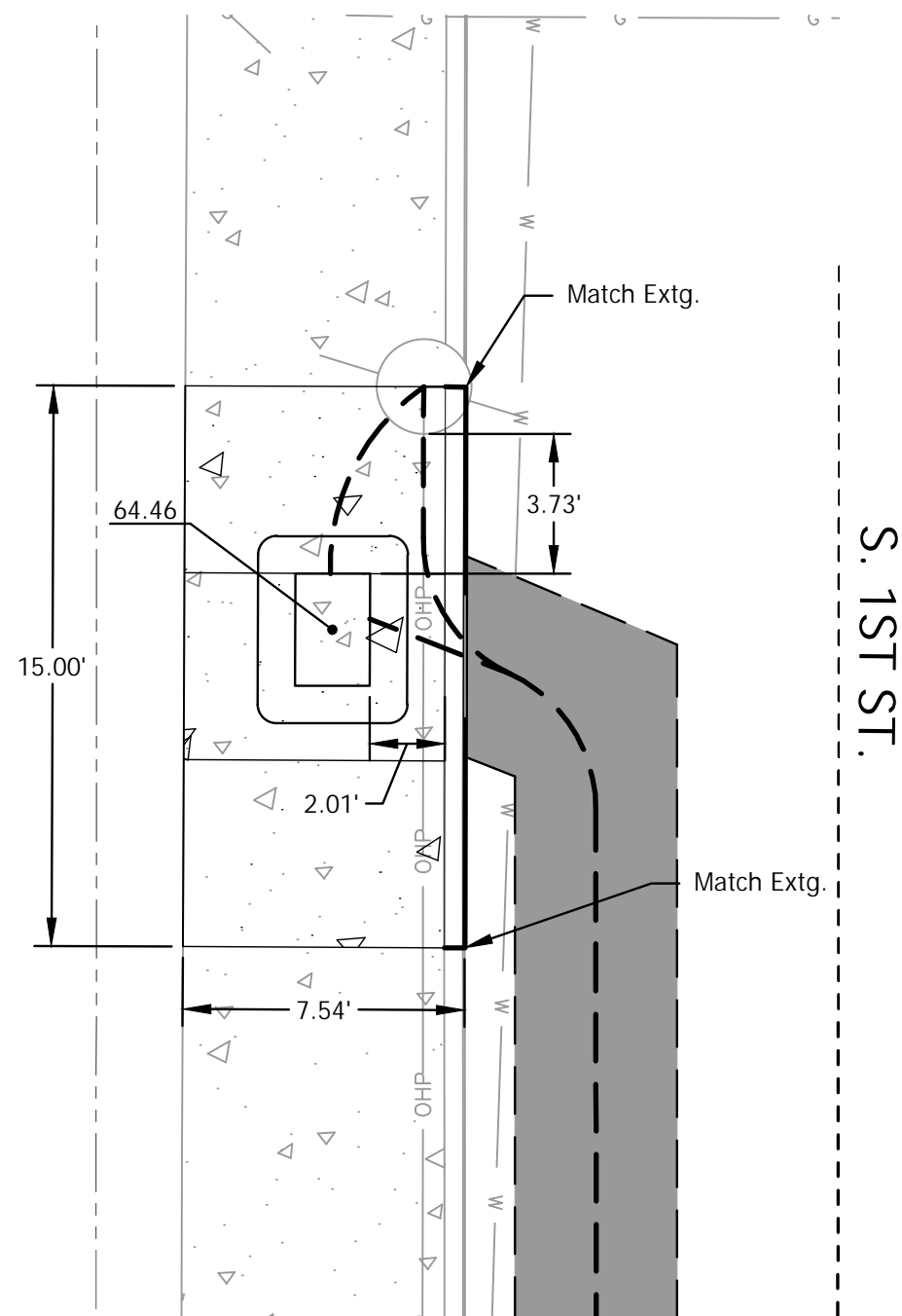

S. 1ST ST.

UTILITY VAULT DETAIL D

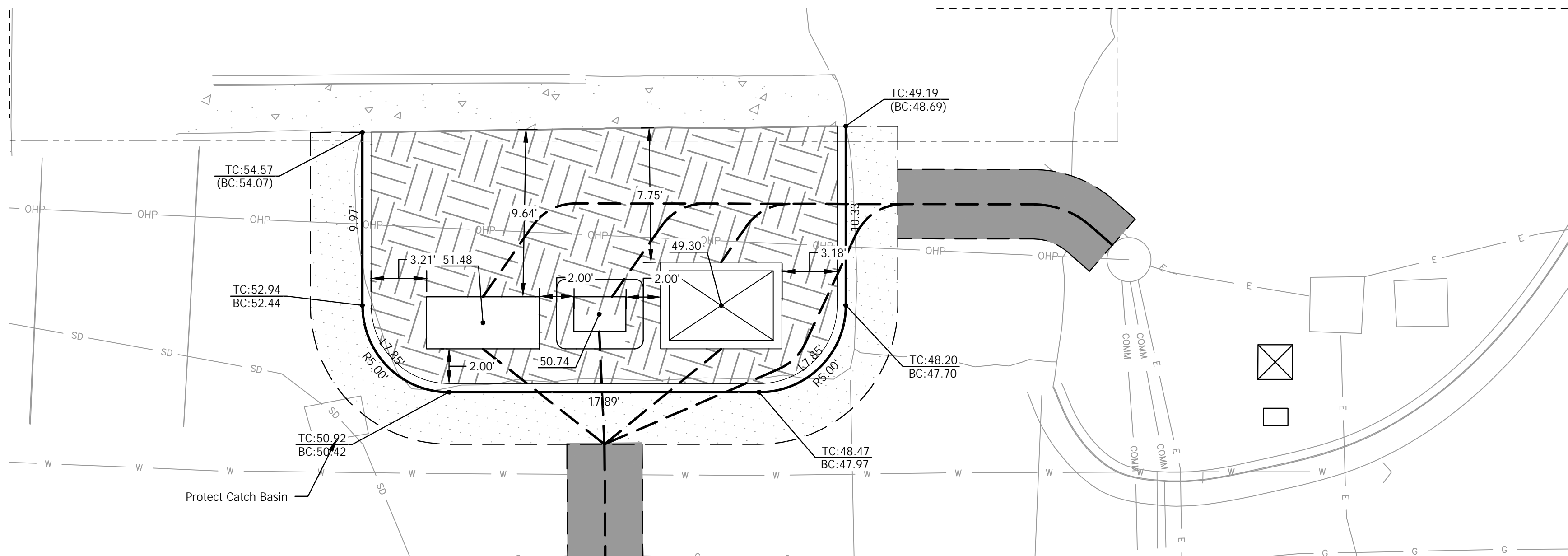

ST. HELENS ST.

UTILITY VAULT DETAIL E

ABBREVIATION

TC = Top of Curb Elevation  
BC = Bottom of Curb Elevation  
FL = Flow Line Elevation  
(XXX.XX) = Match Extg. Grade

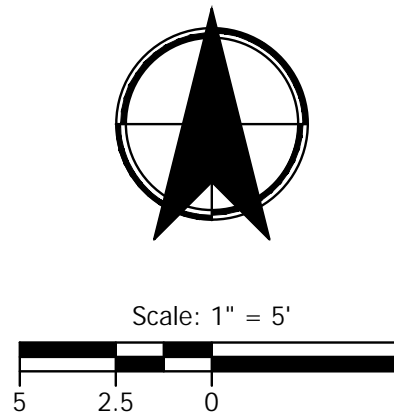

**KITTELSON & ASSOCIATES**

610 SW ALDER STREET, SUITE 700  
PORTLAND, OR 97205  
P 503.228.5230 F 503.273.8169

#	DATE	REVISION	APP'D

Drawn: DZS	Designed: CEC	Checked: AMR
------------	---------------	--------------

Submission Date: 01/12/2024  
PROJECT NO. 23544

S. 1st Street at St. Helens Street  
Franchise Utility Improvements

VAULT DETAILS

SHEET NO. U02

Plot Stamp: 1/11/2024 10:22:40 AM - Caleb Cox  
File: H:\23\23544 - 1st & St. Helens\design\CD-Franchise Utility Plans\U-Franchise Utilities-Joint Utility Plan-23544.dwg

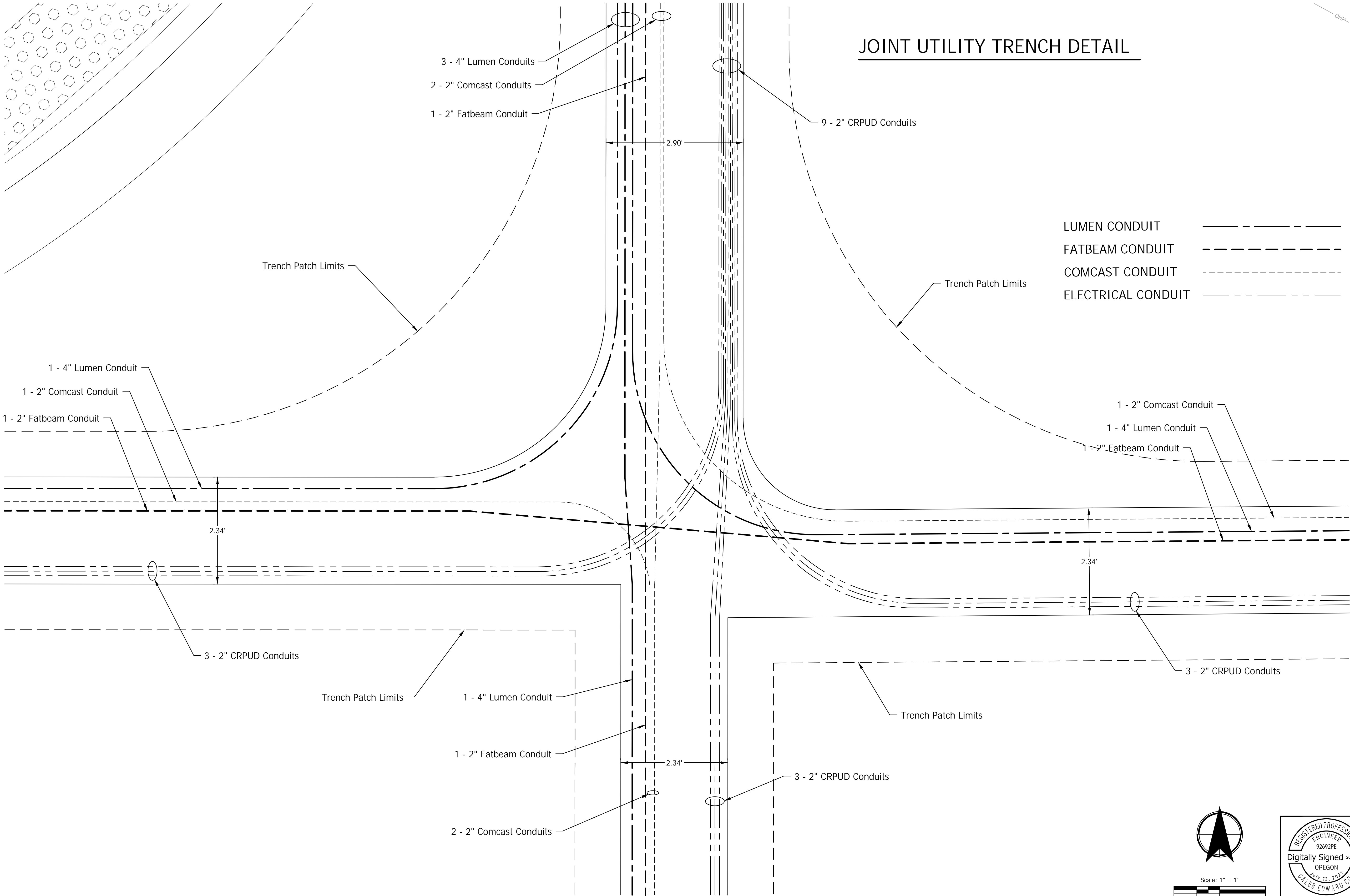

**KITTELSON  
& ASSOCIATES**  
610 SW ALDER STREET, SUITE 700  
PORTLAND, OR 97205  
P 503.228.5230 F 503.273.8169

#	DATE	REVISION	APP'D

Drawn: DZS	Designed: CEC	Checked: AMR
---------------	------------------	-----------------

Submission Date:  
01/12/2024  
PROJECT NO.  
23544

S. 1st Street at St. Helens Street  
Franchise Utility Improvements  
CONDUIT ROUTING DETAILS  
SHEET NO.  
U03

