

TCP C

S. 1st Street at St. Helens Street Franchise Utility Improvements

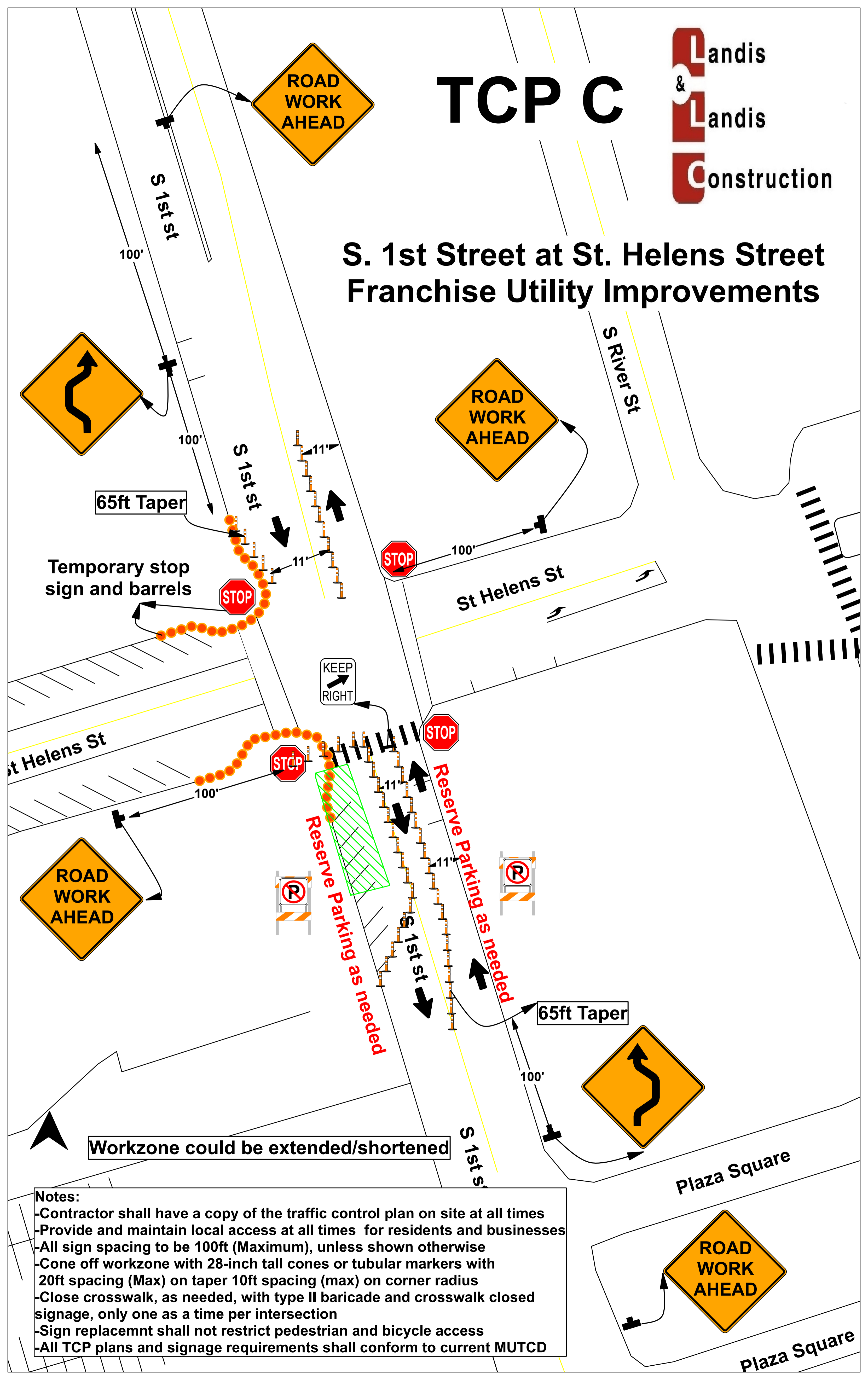

Workzone could be extended/shortened

- Notes:**
- Contractor shall have a copy of the traffic control plan on site at all times
 - Provide and maintain local access at all times for residents and businesses
 - All sign spacing to be 100ft (Maximum), unless shown otherwise
 - Cone off workzone with 28-inch tall cones or tubular markers with 20ft spacing (Max) on taper 10ft spacing (max) on corner radius
 - Close crosswalk, as needed, with type II barricade and crosswalk closed signage, only one as a time per intersection
 - Sign replacement shall not restrict pedestrian and bicycle access
 - All TCP plans and signage requirements shall conform to current MUTCD